



**South Meadow Road**  
St. Crispin, Northampton

**oriordanbond**  
SALES & LETTINGS



GROUND FLOOR  
656 sq.ft. (60.9 sq.m.) approx.

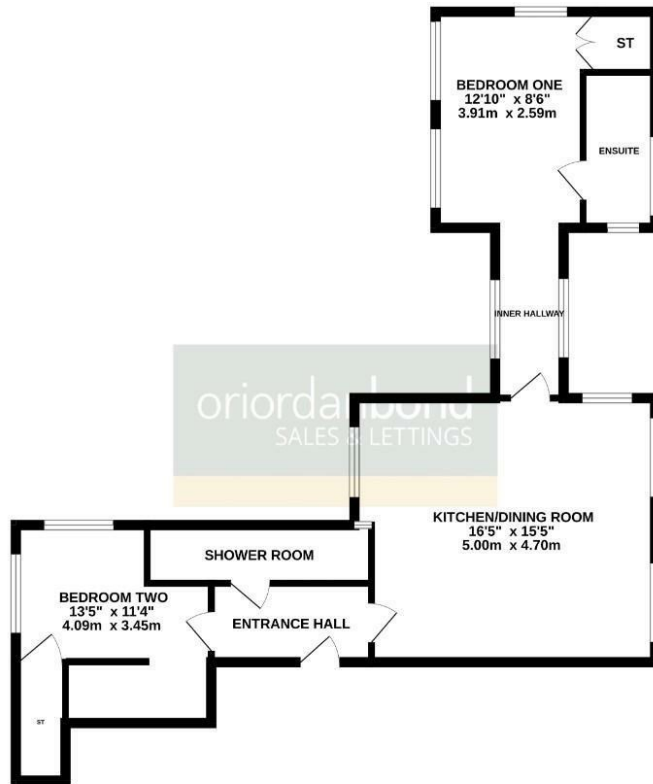

TOTAL FLOOR AREA : 656 sq.ft. (60.9 sq.m.) approx.  
While every attempt has been made to ensure the accuracy of the floorplan contained here, measurements of doors, windows, rooms and any other items are approximate and no responsibility is taken for any error, omission or mis-statement. This plan is for illustrative purposes only and should be used as such by any prospective purchaser. The services, systems and appliances shown have not been tested and no guarantee as to their operability or efficiency can be given.  
Made with Metropix CS2024

## South Meadow Road

St. Crispin  
NN5 4RF

OFFERS OVER £150,000

Offered to the market is this immaculate two bedroom ground floor apartment. Located in the desirable area of St Crispin, 'Keystone House' is set within beautifully maintained grounds and would make an ideal purchase for first time buyers.

Accommodation comprises open plan living area incorporating a fitted kitchen with integrated dishwasher and washing machine, two bedrooms with the master providing an en-suite and fitted wardrobe and a separate shower room. Benefits include a secure intercom entry system, electric heating, double glazing and allocated off road parking for two cars. (A/656/-)

Leasehold Information: Lease Remaining - 107 years (as of 2026) / Ground Rent - £205 per annum / Service Charge - £3800 per annum (includes buildings insurance)

### Additional information

- Council Tax Band: C
- Energy Efficiency Rating: D

### Viewing

Viewing strictly by appointment – details below

### Disclaimer

O'Riordan Bond Estate Agents Limited has not tested apparatus, equipment, fittings or services and so cannot verify they are in working order. The buyer is advised to obtain verification from their solicitor or surveyor.

O'Riordan Bond Duston Sales  
01604 589007

duston@oriordanbond.co.uk

